

NOTE: THIS IS CONFIDENTIAL PROPERTY OF BMC. IT IS NOT TO BE COPIED OR DUPLICATED IN ANY MANNER AND SHALL NOT BE SUBMITTED TO OUTSIDE PARTIES WITHOUT OUR WRITTEN CONSENT.

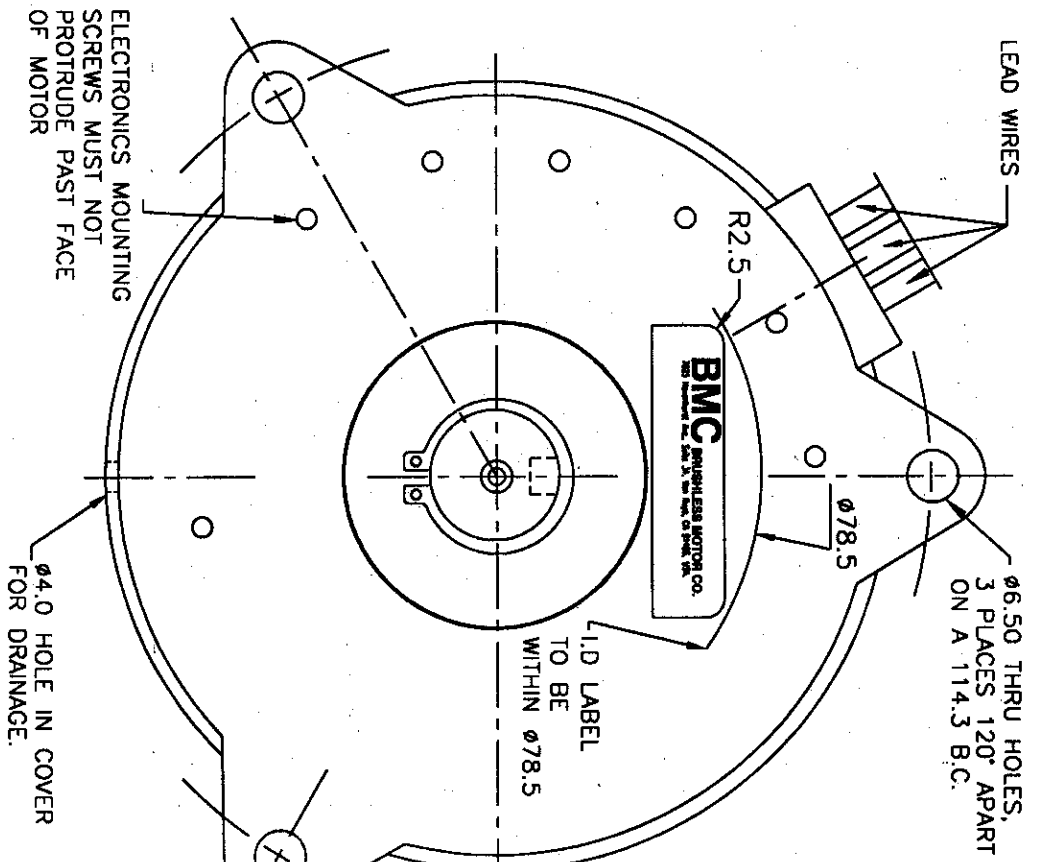

PART NO	PERFORMANCE SPEC.	DESIGNATION
12160-1	51.1 250 WATTS	HI-MAC 1
-2	60.1 400 WATTS	HI-MAC 2
-3	79.1 600 WATTS	D-MAC

NOTE:

1. CABLE LENGTH SHOULD BE 292±6MM FROM BASE PLATE END TO CONNECTOR END
2. DRIVE ELECTRONICS MOUNTED INSIDE THE MOTOR.
3. ALL DIMENSIONS ARE IN MM.

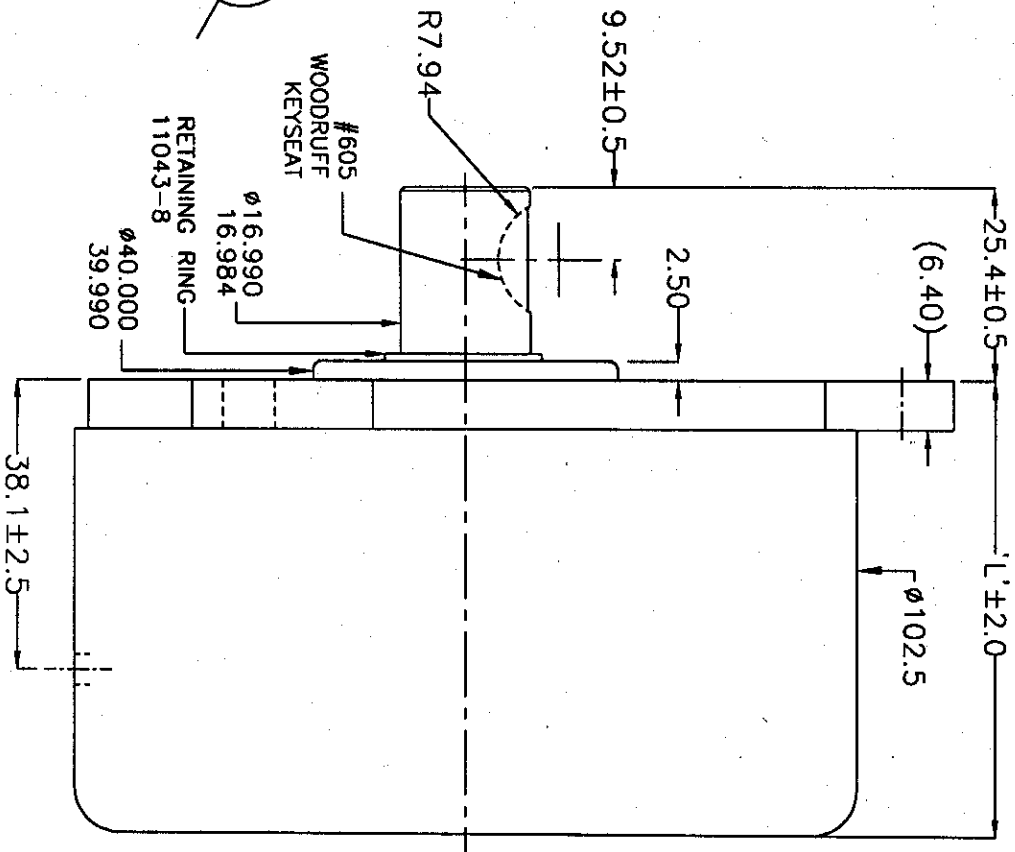

REV.	DATE	BY	ECN	REMARKS	CK

TOLERANCES UNLESS NOTED	✓ ANGULARITY ○ CONCENTRICITY ○ PERPENDICULARITY ○ REFERENCE DIM. ○ DIAMETER	DRAWN BY:	BMC BRUSHLESS MOTOR CO. 3625 HANFORD AVE., SUITE 34, VAN NUYS, CA 91406, USA
.0 ±.25 .00 ±.13 ANGLE ± 2° (X) REF. DIM.	1 (X)	CHECKED BY: SGN	
MATERIAL		DATE:	MOTOR OUTLINE 36 FRAME
		03 APRIL 2003	12160C